

ML994_PH Phenolic Folding Shower Seat

Material Specifications

- #304 Satin Stainless-Steel Frame and Support Arm- 25mmØ Tube
- #304 Satin Stainless-Steel Wall Mount Guide Bracket
- 12mmT Off White Phenolic Compound Single Piece Seat with Black Edging & 6mm Drainage Slots

Dimensions

- 960mmW x 363mmH x 397±3mmD

Mounting

- Surface Mount Visible Fix

Installation Guidelines

- *May be subject to Australian Building Code Regulations for height and location fixing and may be subject to placement as per architectural drawings. In all cases, this is the responsibility of the installer.*
 - *Fixings and anchors are not included with the units and are the responsibility of the installer to appropriately fix the unit to the wall. The supporting wall must be adequately reinforced to carry the weight load.*
1. Secure the 2 wall mount brackets to the wall using appropriate fixings, ensure that they are level.



2. Secure the main seat support bar to the wall using the 4 mounting holes in the bracket.

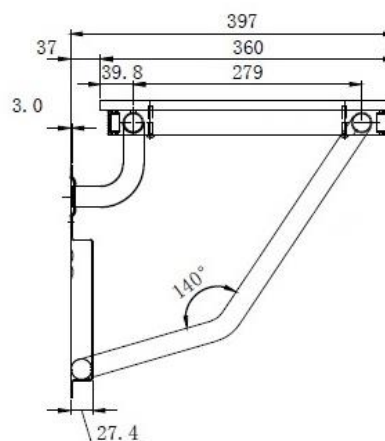
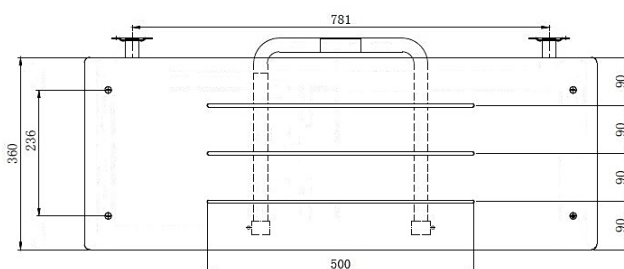
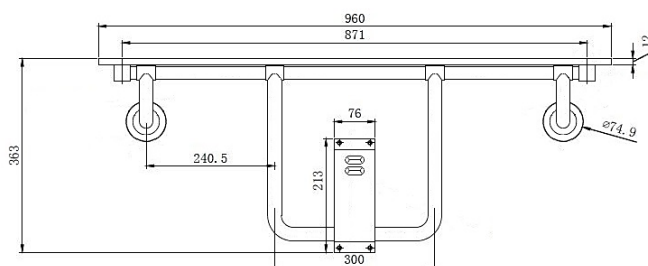

The photographs and line drawings of the products presented above are representational only.
Metlam Australia Pty Ltd reserves the right to, and from time to time, make changes and improvements in design and dimensions.

3. Ensure that the seat folds freely from the upright position to the lowered position. The support bar will slide from the top of the mounting bracket to the bottom of the mounting bracket.



4. When seat is moved to the upright position, check to ensure that it will remain in this position until lowered.
5. Check that the seat is level and all fixings have been tightened to complete installation.

Operation

- Guide Bracket shall control seat lowering into operating position.

Features

- Phenolic material defends against stains and wear and tear, it is also moisture resistant. The materials extreme durability is suited for use in schools, universities, shopping centres, hotels, wet areas and healthcare facilities.
- Fold away lockable support arm with wall mount guide bracket.
- Low profile upright storage position (support arm will fold up).

Safety Warning

- Ensure that there is proper structure support within the wall. Shower seats are no stronger than the anchors and walls to which they are attached. Shower seats must be firmly secured in order to support the loads for which they are intended.

The photographs and line drawings of the products presented above are representational only.
Metlam Australia Pty Ltd reserves the right to, and from time to time, make changes and improvements in design and dimensions.



This product is AS1428.1 compliant (accessible compliant) when installed in accordance with the guidelines.

The technical recommendations contained in this document are necessarily of a general nature and should not be relied on for specific applications without first securing competent advice. Whilst Metlam Australia Pty Ltd has taken all reasonable steps to ensure the information contained herein is accurate and current, it does not warrant the accuracy or completeness of the information and does not accept liability for errors or omissions. Any Commercial product should only be installed by a competent tradesperson and serviced/maintained by knowledgeable janitorial staff or competent people. Metlam Australia accepts no responsibility for any damage to product, walls or fixtures due to incorrect installation or maintenance of any of their products.

The photographs and line drawings of the products presented above are representational only.
Metlam Australia Pty Ltd reserves the right to, and from time to time, make changes and improvements in design and dimensions.